

**ARKANSAS DEPARTMENT OF ENVIRONMENTAL QUALITY
NOTICE OF INTENT
LANDFILL SANITARY DISCHARGE
NPDES GENERAL PERMIT ARG160000**

Application Type: New Renewal (Permit # ARG16 0028)

I. PERMITTEE/OPERATOR INFORMATION

Permittee (Legal Name): Waste Corporation of Arkansas, LLC Operator Type:
Permittee Mailing Address: 1420 Hamric Road State Partnership
Permittee City: Hazen Federal Corporation*
Permittee State: AR Zip: 72064 Sole Proprietorship/Private
Permittee Telephone Number: (870)255-4001 *State of Incorporation: DE
Permittee Fax Number: (870) 255-4109 The legal name of the Permittee must be
Permittee E-mail Address: tphillips@wcamerica.com identical to the name listed with the
Arkansas Secretary of State.

II. INVOICE MAILING INFORMATION

Invoice Contact Person: Todd Phillips City: Hazen
Invoice Mailing Company: Waste Corporation of Arkansas, LLC State: AR Zip: 72064
Invoice Mailing Address: 1420 Hamric Road Telephone: (870) 255-4001

III. FACILITY INFORMATION

Facility Name: Rolling Meadows Landfill, Inc. Facility Contact Person: Todd Phillips
Facility Address: 1420 Hamric Road Telephone Number: (870) 255-4001
Driving Directions to Facility: I-40 East to Hwy 11 (Exit 193), 2.2 miles north to County Rd 518 (Landfill Rd), 1.1 miles west to facility
Facility County: Prairie Facility City, State & Zip: Hazen, AR 72064
Facility Latitude: 34 Deg 50 Min 54Sec Facility Longitude: -91 Deg 35 Min 26.96Sec
Facility SIC Code: 4953 Refuse Systems Facility NAICS: 562212

IV. DISCHARGE INFORMATION

Outfall Number: 001 Estimated Flow: 0.864 MGD (Million Gallons per Day)
Outfall Description: Pumped discharge from Detention Pond No. 1
Stream Segment: 4D Hydrologic Basin Code: 08020301
Outfall Latitude: 34 Deg 51 Min 00.84Sec Outfall Longitude: -91Deg 35 Min 13.23Sec
Receiving Stream: Unnamed trib to Payne Crk, thence to Barnes Crk, thence to Wattensaw Bayou, thence to White River
Outfall Number: 002 Estimated Flow: 0.93 MGD (Million Gallons per Day)
Outfall Description: Pumped discharge from Detention Pond No. 2
Stream Segment: 4D Hydrologic Basin Code: 08020301
Outfall Latitude: 34 Deg 51 Min 23.02Sec Outfall Longitude: -91Deg 35 Min 26.13Sec
Receiving Stream: Unnamed trib to Payne Crk, thence to Barnes Crk, thence to Wattensaw Bayou, thence to White River

WATER DIVISION
5301 NORTHSHORE DRIVE / NORTH LITTLE ROCK, ARKANSAS 72118
PHONE 501-682-0623 / FAX 501-682-0880
www.adeg.state.ar.us Revised 8/2014

V. CONSTRUCTION REQUIREMENTS

	Yes	No
Is this permit covering the construction of a sedimentation pond?	<input type="checkbox"/>	<input checked="" type="checkbox"/>
If yes, have you included Arkansas Form 1 and design, plans and specifications (including the requirements in Part 1.3.2 of the permit) stamped by a Professional Engineer registered in the State of Arkansas?	<input type="checkbox"/>	<input type="checkbox"/>
Is this facility within the area of the Boone or St. Joe formations? Map available at : http://www.adeq.state.ar.us/water/branch_permits/general_permits/default.htm	<input type="checkbox"/>	<input checked="" type="checkbox"/>

VI. FACILITY PERMIT INFORMATION

NPDES Individual Permit Number (If Applicable): AR00
NPDES General Permit Number (If Applicable): ARG160028
State Construction Permit Number: _____
NPDES General Construction Stormwater Permit Number (If Applicable): ARR15
NPDES Industrial Stormwater General Permit Number: ARR00
Other Department Permits: 1888-AOP-R0; 0253-S1-R6

VII. OTHER INFORMATION:

Additional Location Description: _____
Additional Comments: _____
Consultant Contact Name: Ray Wieda, PE
Consultant Email Address: rew@ftn-assoc.com
3 Little
Consultant Address: Innwood City: Rock State: AR Zip: 72211
Consultant Phone Number: (501) 225-7779 Consultant Fax Number: (501) 225-6738

VIII. CERTIFICATION OF OPERATOR

"I certify that, if this facility is a corporation, it is registered with the Secretary of the State of Arkansas. I certify that the cognizant official designated in this Application is qualified to act as a duly authorized representative under the provisions of 40 CFR 122.22(b). If no cognizant official has been designated, I understand that the Department will accept reports signed only by the Applicant. I certify under penalty of law that this document and all attachments were prepared under my direction or supervision in accordance with a system designed to assure that qualified personnel properly gather and evaluate the information submitted. Based on my inquiry of the person or persons directly responsible for gathering the information, the information submitted is, to the best of my knowledge and belief, true, accurate, and complete. I am aware that there are significant penalties for submitting false information, including the possibility of fine and imprisonment for knowing violations."

Responsible Official Printed Name: Todd Phillips Title: General Manager
Responsible Official Signature: *Todd Phillips* Date: 3, 25, 15
Responsible Official Email: tphillips@wcamerica.com
Cognizant Official Printed Name: _____ Title: _____
Cognizant Official Signature: _____ Telephone: _____
Cognizant Official Email: _____

WATER DIVISION
5301 NORTHSHORE DRIVE / NORTH LITTLE ROCK, ARKANSAS 72118
PHONE 501-682-0623 / FAX 501-682-0880
www.adeq.state.ar.us Revised 8/2014

IX. PERMIT REQUIREMENT VERIFICATION

Please check the following to verify completion of permit requirements. If you answer "NO" to any of questions below the application will be considered incomplete and cause a delay in the permitting process.

	Yes	No	
Submittal of Complete NOI?	<input checked="" type="checkbox"/>	<input type="checkbox"/>	
Submittal of Required Permit Fee?	<input checked="" type="checkbox"/>	<input type="checkbox"/>	New Permittees Only Check Number: _____
Submittal of Topographic Map?	<input checked="" type="checkbox"/>	<input type="checkbox"/>	
Submittal of Disclosure Statement?	<input checked="" type="checkbox"/>	<input type="checkbox"/>	
Industrial Operator's License Number:	_____		

Department of State: Division of Corporations

HOME

- About Agency
- Secretary's Letter
- Newsroom
- Frequent Questions
- Related Links
- Contact Us
- Office Location

SERVICES

- Pay Taxes
- File UCC's
- Delaware Laws Online
- Name Reservation
- Entity Search
- Status
- Validate Certificate
- Customer Service
- Survey

INFORMATION

- Corporate Forms
- Corporate Fees
- UCC Forms and Fees
- Taxes
- Expedited Services
- Service of Process
- Registered Agents
- Get Corporate Status
- Submitting a Request
- How to Form a New Business Entity
- Certifications, Apostilles & Authentication of Documents

[Privacy Policy](#) [Frequently Asked Questions](#) [View Search Results](#) [Summary of Charges](#) [Logout](#)

Entity Details

File Number: 3291243 **Incorporation Date / Formation Date:** 09/21/2000 (mm/dd/yyyy)

Entity Name: WASTE CORPORATION OF ARKANSAS, LLC

Entity Kind: LIMITED LIABILITY COMPANY (LLC) **Entity Type:** GENERAL

Residency: DOMESTIC **State:** DE

Status: GOOD STANDING **Status Date:** 09/21/2000

REGISTERED AGENT INFORMATION

Name: CORPORATION SERVICE COMPANY

Address: 2711 CENTERVILLE RD SUITE 400

City: WILMINGTON **County:** NEW CASTLE

State: DE **Postal Code:** 19808

Phone: (302)636-5401

Additional Information is available for a fee of \$20.00. This information will include current franchise tax assessment, current filing history and more..

Would you like Tax & History Information

To contact a Delaware Online Agent [click here](#).

Temple, Jessica

From: Ray Wieda <rew@ftn-assoc.com>
Sent: Friday, May 01, 2015 3:58 PM
To: Temple, Jessica
Cc: 'Paul Crawford'; 'Mark Koch'
Subject: RE: ARG160028, Rolling Meadows Landfill, Inc.

Hi Jessica,

FTN has confirmed that the sedimentation pond at Rolling Meadows Landfill has been designed and constructed to contain runoff from a 25-year, 24-hour storm event.

Please let me know if you need any additional information.

Thanks,
Ray

From: Temple, Jessica [<mailto:TEMPLEJ@adeq.state.ar.us>]
Sent: Wednesday, April 29, 2015 9:01 AM
To: 'Ray Wieda'
Subject: RE: ARG160028, Rolling Meadows Landfill, Inc.

Thanks Ray. Just one more thing: can you confirm that the sedimentation pond has been designed and constructed with a storage capacity to handle runoff from a 25-year, 24-hour storm event?

Thanks,
Jessica Temple
Engineer
ADEQ-Water Division
501-682-0621

From: Ray Wieda [<mailto:rew@ftn-assoc.com>]
Sent: Friday, April 24, 2015 3:45 PM
To: Temple, Jessica
Cc: tphillips@wcamerica.com; 'Ethan Shackelford'; 'Mark Koch'
Subject: RE: ARG160028, Rolling Meadows Landfill, Inc.

Jessica,

Please accept the following in response to the issues raised in the email below. I apologize for the delay in responding.

- In lieu of a Disclosure Statement, please find attached the most recent quarterly and annual SEC filings for Waste Management (WM). WM is the parent company of Waste Corporation of Arkansas, LLC.

- Please find attached a revised NOI with the correct permittee name (Waste Corporation of Arkansas, LLC). Also attached is a screenshot from the Delaware Department of State website showing that Waste Corporation of Arkansas, LLC is in good standing.
- Receipt of the check was acknowledged in your email dated April 1, 2015.
- There are currently no licensed operators at this facility. Facility personnel will begin the process of obtaining the proper wastewater license and hope to have this accomplished by July. In the interim, the facility has contracted with FTN to serve as their licensed operator. Ken Carmichael (License No. 004758) will serve in that capacity.
- Yes, the operational procedures dictate that the sedimentation ponds be dewatered as soon as possible after sufficient settling has occurred.

Please let me know if you need any additional information.

Thanks,
Ray

From: Temple, Jessica [mailto:TEMPLEJ@adeq.state.ar.us]
Sent: Thursday, March 26, 2015 2:19 PM
To: 'rew@ftn-assoc.com'
Cc: 'tphillips@wcamerica.com'
Subject: ARG160028, Rolling Meadows Landfill, Inc.

Ray,

The Department is in receipt of the NOI and map for the renewal of ARG160028. There are some items that need to be addressed before the permit can be processed.

- The email from yesterday states that a disclosure statement was submitted to the Solid Waste division. I can't find a copy of that, could you please send me a copy?
- The permittee name on the NOI ("Waste Corporation of Arkansas, Inc.") has a status with the Arkansas Secretary of State as converted. It is necessary that the permittee name be in good standing with the AR Secretary of State. It does look like "Waste Corporation of Arkansas, LLC " is in Good Standing with the Arkansas Secretary of State. Also, we will need documentation showing that the company is in Good Standing with the Delaware Secretary of State as well.
- The email from yesterday states that a check is to be hand delivered. Can you please tell me who the check is from, and the check number so that I can confirm receipt with our fiscal division?
- What is the operator's name and license number?
- Can you confirm that the ponds covered by this permit do not receive stormwater from active portions of the landfill?
- Can you also confirm that operational procedures at the landfill include a requirement that the sedimentation ponds are dewatered as soon as possible after a storm event and after sufficient settling to ensure that no effluent limitations are exceeded?

Please let me know if you have any questions or concerns. You can return any documents via email if that is convenient for you.

Thanks,
Jessica Temple
Engineer

From: [Ray Wieda](#)
To: [Water Permit Application](#)
Cc: "Mark Koch"; [Ethan Shackelford](#); [Todd Phillips](#); "Jason J Ghidotti, PE"; [Paul Crawford](#)
Subject: Notice of Intent for ARG160028
Date: Wednesday, March 25, 2015 3:58:47 PM
Attachments: [image003.png](#)
[NOI for ARG160028.pdf](#)

Please find attached a Notice of Intent from Waste Corporation of Arkansas, Inc. seeking to renew coverage for the Rolling Meadows Landfill (AFIN 59-00036) under the Sanitary Landfill General Permit (ARG160028).

Please note that a Disclosure Statement has been previously submitted to the Solid Waste Division and a check for the permit fee will be hand delivered this afternoon.

Please contact me or Mark Koch at 501-225-7779 with any questions or concerns.

Regards,
Ray



Raymond E. Wieda, PE
FTN Associates, Ltd.
3 Innwood Circle, Suite 220 • Little Rock, AR 72211 (501) 225-7779 • fax (501) 225-6738
rew@ftn-assoc.com <http://www.ftn-assoc.com>

DATE	12/1/09	SHEET NO.	1 OF 1
SCALE	1" = 200'	PROJECT NO.	6533-221
APPROVED	DATE	DRAWN BY	DATE
<i>[Signature]</i>		<i>[Signature]</i>	

WCA WASTE CORPORATION OF ARKANSAS, INC.
STORMWATER POLLUTION PREVENTION PLAN
HAZEN, ARKANSAS

SITE MAP

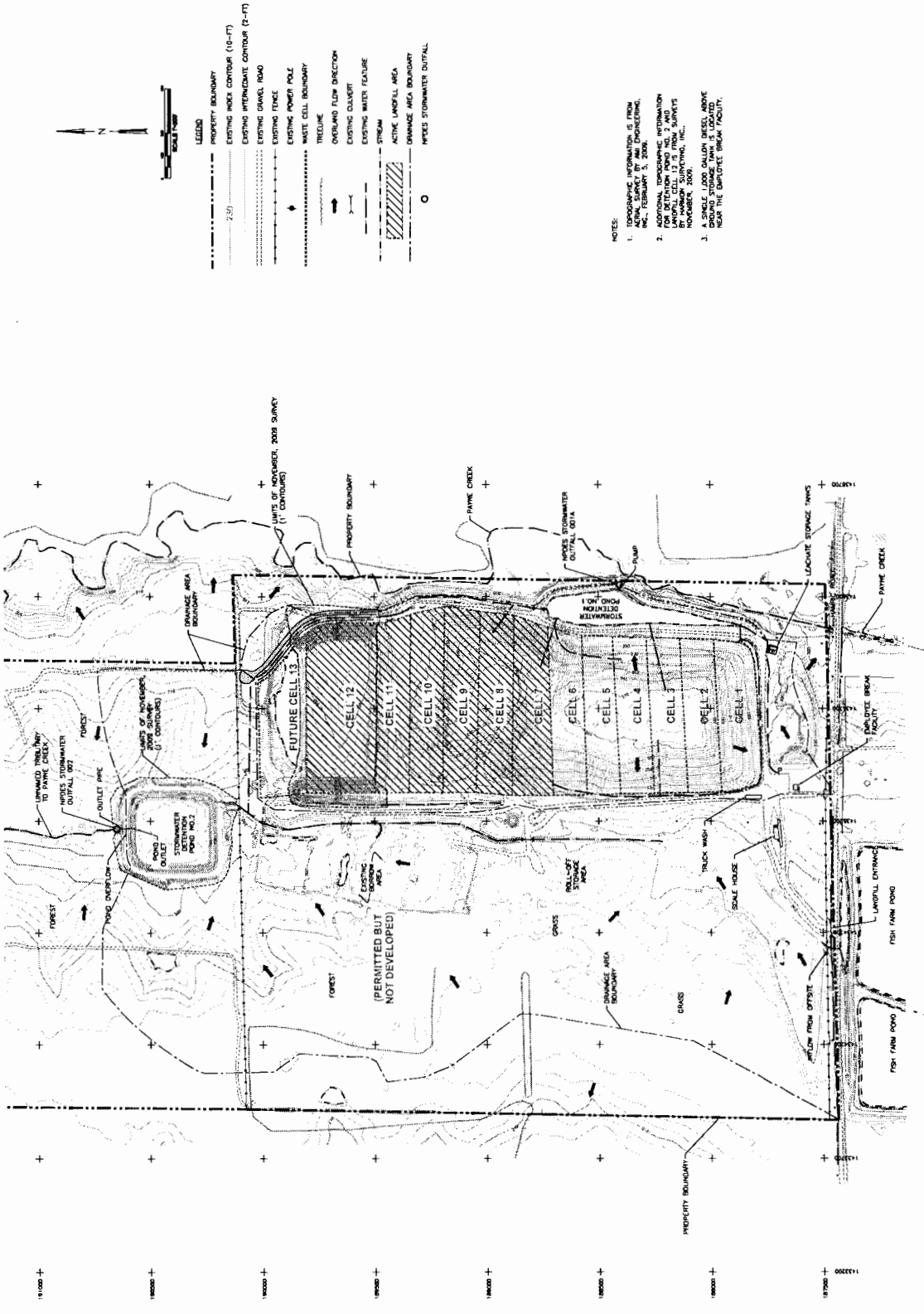

- NOTES:**
1. ADDITIONAL INFORMATION IS FROM AERIAL PHOTOGRAPHS BY AM CONSULTING, INC., FEBRUARY 5, 2009.
 2. ADDITIONAL TOPOGRAPHIC INFORMATION FOR THIS PROJECT IS FROM SURVEYS CONDUCTED BY AM CONSULTING, INC., NOVEMBER 2009.
 3. A SINGLE 1,000 GALLON WHEEL LOAD BRICK STORAGE TANK IS LOCATED NEAR THE EMPLOYEE BREAK FACILITY.



ARKANSAS
SECRETARY OF STATE

Mark Martin

Search Incorporations, Cooperatives, Banks and Insurance Companies

[Printer Friendly Version](#)

LLC Member information is now confidential per Act 865 of 2007

Use your browser's back button to return to the Search Results

Begin New Search

For service of process contact the [Secretary of State's office](#).

Corporation Name	WASTE CORPORATION OF ARKANSAS, LLC
Fictitious Names	
Filing #	800190579
Filing Type	Foreign Limited Liability Company
Filed under Act	Foreign LLC; 1003 of 1993
Status	Good Standing
Principal Address	1330 POST OAK BLVD, 30TH FLOOR HOUSTON, TX 77056
Reg. Agent	CORPORATION SERVICE COMPANY
Agent Address	300 SPRING BUILDING SUITE 900 300 S SPRING STREET LITTLE ROCK, AR 72201
Date Filed	12/21/2010
Officers	WILLIAM CAESAR , Manager TOM J. FATJO , Incorporator/Organizer DELOITTE TAX, LLP, Tax Preparer
Foreign Name	N/A
Foreign Address	ONE RIVERWAY SUITE 1400 HOUSTON, 77056
State of Origin	DE
Purchase a Certificate of Good Standing for this Entity	Pay Franchise Tax for this corporation